

Select "Processes" from the main menu.

To edit an existing diagram map click on its name. To create a new diagram map click "New map"

Change space



NEW MAP

Name

Owner

Access

Salesforce Data Model

Jack Lavous

edit

Elements for Salesforce Partner Learning Trails

Richard Parker

view

Items per page: 10

1 - 2 of 2



Salesforce Data Model

Copy map

Invite to map

All users can view map

All users with access can copy map

All users with access can grant access

Shared with



Jack Lavous
jack@elements.cloud

Owner [Change](#)

Map managers: 1

Map editors: 2



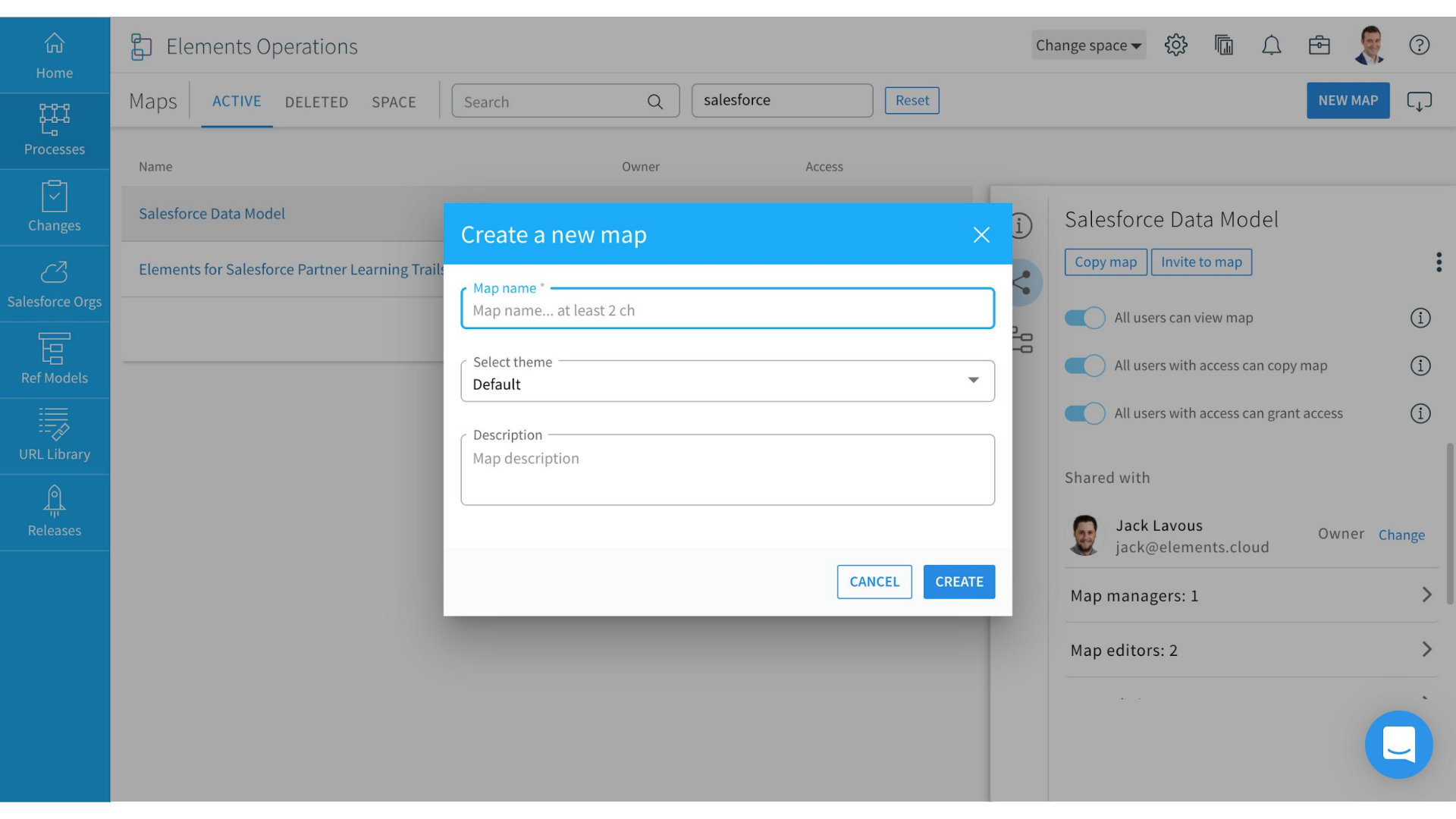

Maps

ACTIVE DELETED SPACE

Search 

salesforce

Reset

NEW MAP



Name Owner Access

Salesforce Data Model

Elements for Salesforce Partner Learning Trails

Create a new map



Map name *

Map name... at least 2 ch

Select theme

Default

Description

Map description

CANCEL

CREATE

Salesforce Data Model

Copy map

Invite to map

All users can view map

All users with access can copy map

All users with access can grant access

Shared with

 Jack Lavous
jack@elements.cloud

Owner [Change](#)

Map managers: 1

Map editors: 2





Draft

- SHAPES
- Drag and Drop onto Canvas
- Activity box
- Flowline
- Text
- Sticky note
- Image
- Hints & Tips

You can drag and drop components onto the canvas from the left panel.

Click on "?" in the toolbar for shortcuts & additional instructions.

Tab Select next activity box

Shift + Tab Select previous activity

Cmd + C / Cmd + V Copy/Paste selected element

Delete/Backspace Delete selected elements

Cmd + A Select all

Cmd + Shift + A Select vertices

Cmd + Z Undo changes

Cmd + Shift + Z Redo changes

Cmd + L Lock/Unlock selected element

Double left mouse click Create activity box

Alt + double left mouse click Create text

Shift + double left mouse click Create sticky note

Cmd + double left mouse click Create activity box with flowline

Cmd + E Switch to view mode

Help/more contextual information

Sub-process

[Need more help? Open support library](#)

